

# VISION3 LIGHTING

## LED Sign Light MODEL SL2 120-277V, 15W Max. Integral Driver COB LED 30W Max. COB LED (Remote Driver Required)

### Specifications

#### Material

Machined 6061-T6 aluminum with 18-8 stainless steel hardware.

#### Head

Machined head comes in two styles: Side Mount and Rear Mount. (See illustration for aiming capability of each head style.)

#### Stem

1" diameter machined stem comes in various stem lengths and three stem styles: Straight, 180° U-Bend, and 90° Gooseneck. (See illustration for calculating overall projection from wall for each stem style.)

#### Knuckle

Rotate and Lock knuckle (protected under U.S. Patents #6,966,679, #7,108,405 and #7,458,552) mounts the head to the stem and allows aiming. Double taper design allows fixture to hold position during aiming and ensures a solid lock when tightened. LED models have a molded silicone wire seal to prevent water entry at knuckle.

#### Cap

Machined caps come in seven styles, lock in place with one 18-8 stainless steel set screw, and are sealed to the body with a high temperature silicone O-ring. Regress Lens caps have drain holes for water drainage from top of lens if mounted in the up position. All caps accept two internal accessories, held in place by a stainless steel clip.

#### Mount Canopy

Available with the following mount options: MO3 (Machined Round Canopy), MO15 (Machined Square Canopy), and MO12 (Machined Square Canopy), and MO12



(Surface Mount Canopy). Stem is permanently attached to mount canopy using a 304 stainless steel threaded nipple to prevent loosening or sagging. See mount specification sheets for more information. (Mount canopy must be mounted to an appropriate wall or junction box, in such a manner that is capable of holding the weight and torque created by the fixture. Junction box and hardware not included).

#### Finish

TGIC thermo set polyester powder coat paint available in 14 standard colors. Finish is applied over a corrosion resistant, hexavalent chromium free, RoHS compliant coating. Also available in one additional metal finish: Clear Anodized.

#### Lens

1/8" thick, tempered, clear lens, secured to cap with a high temperature, UV curing, silicone adhesive.

#### Light Engine

Both COB LED light engine options use industry standard replaceable components and quick disconnects for ease of field maintenance and future upgrades, and includes features like: field changeable optics (15°, 24°, 36°, 55°, 65°), choice of color temperature (2700K, 3000K, 3500K, 4000K), CRI (80, 90), and an L70 > 50,000 hrs.

#### Integral Driver COB LED option:

Includes a field replaceable driver module with a 350mA, 15W max Class 2 driver for features like: 1600lm<sup>7</sup> max. nominal output, 105 lm/W efficacy, 120-277VAC (50/60Hz)

input, programmable tri-dimming (TRIAC, ELV, 0-10V) down to 1%, and various protection features (input over current, short circuit and over current, internal over temperature, output open load). Notes: driver can be programmed for dimming profile or lower lumen output. Contact V3 for info. For compatible dimmers, see Compatible Dimmer list.

#### COB LED option:

Requires Vision3 approved constant current remote driver or driver mount (to be specified separately). Includes performance of 1800lm<sup>7</sup> @ 350mA, 2400lm<sup>7</sup> @ 500mA, 3200lm<sup>7</sup> @ 700mA.

Note: see specification sheet of driver mount being specified for appropriate driver ratings.

#### Certification

CSA tested & certified to US and Canadian safety standards per UL1598 for wet location use in wall mount applications.

#### Integral Driver COB LED:

Integral driver COB LED available in all configurations.

#### COB LED:

SL2A - 700mA max driver current.

All ratings subject to change without notice. See web site or contact V3 for most current info.

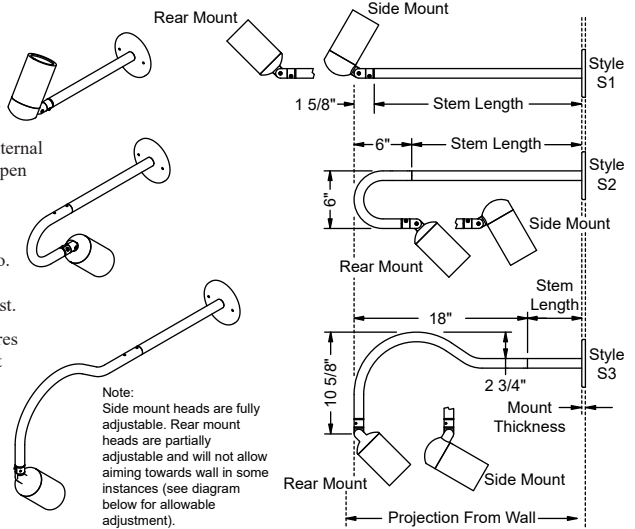

Projection From Wall = Stem Length + Mount Thickness + 6" (for Style S2)  
15/8" (for Style S1)  
18" (for Style S3)

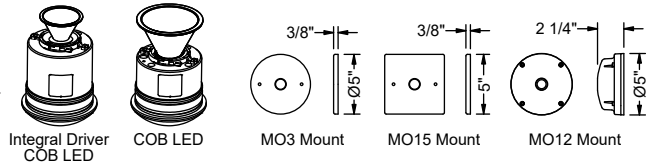
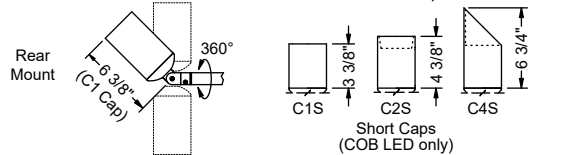
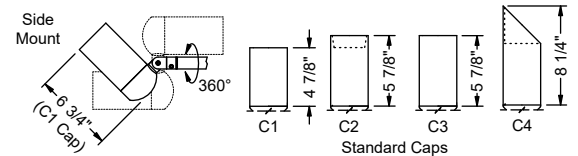

### Ordering Information

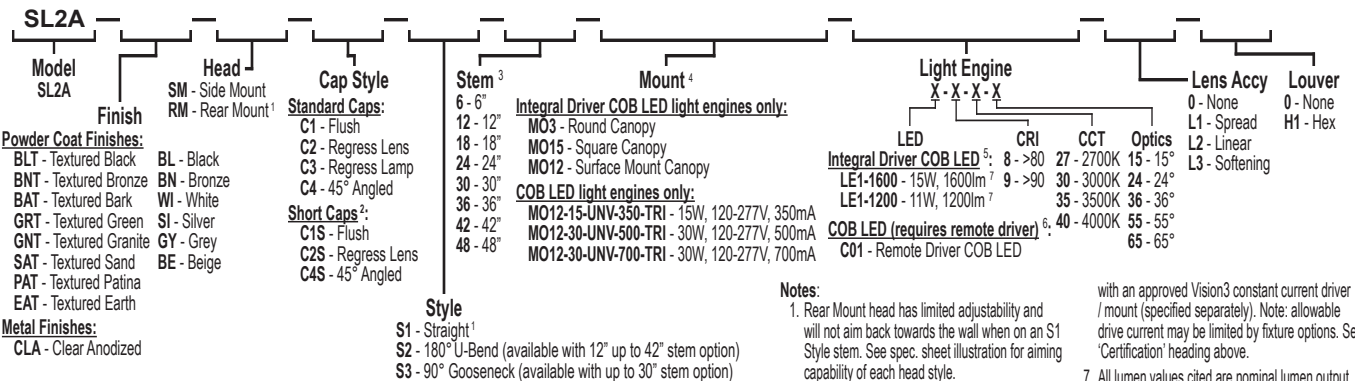

#### Notes:

1. Rear Mount head has limited adjustability and will not aim back towards the wall when on an S1 Style stem. See spec. sheet illustration for aiming capability of each head style.
2. Short cap options only available with COB LED Light Engine options.
3. Other stem lengths are available upon request. Consult your Vision3 Lighting sales representative.
4. See mount specification sheet for mount details.
5. Integral Driver COB LED Light Engine options do not require a separately specified remote driver. See specifications above for required voltage input.
6. COB LED Light Engine options must be used with an approved Vision3 constant current driver / mount (specified separately). Note: allowable driver current may be limited by fixture options. See 'Certification' heading above.
7. All lumen values cited are nominal lumen output (ideal lumen output of light engine only in lab conditions). Actual fixture output will vary with cap type, material, lens/optics options, and environmental conditions. For more accurate information, see fixture photometry files on website.
8. Specifications, certifications, and ordering information are subject to change. Please check website for latest specification sheets.

Example: SL2A - BN - SM - C3 - S3 - 24 - MO3 - LE1-1600-8-35-65 - 0 - 0